

A6328-1-CF

REV

10/3/2013

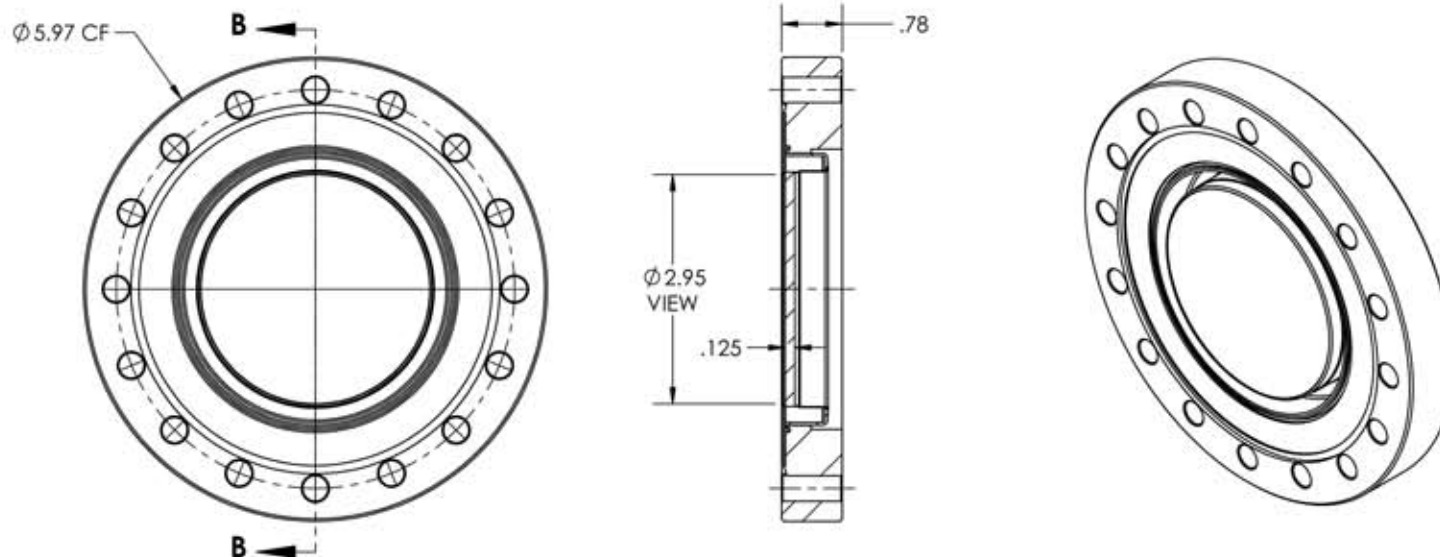

SPECIFICATIONS:

1. Leak Rate: $<2 \times 10^{-10}$ atm cc/sec He
2. Parallelism: <3 Arc Minutes
3. Surface Finish: 50/20 Scratch-Dig
4. Thermal Range: -100°C TO 450°C
5. UV Transmission: 50% @ 250nm (External)
6. Orientation: $0-90^{\circ}$

APPROVED

UV Grade Sapphire Viewport, 2.95" View Dia,
6" Conflat Flange

TITLE:

VIEWPORT, SAPPHIRE, UV,
3.0 VIEW, 600CF

PROPRIETARY AND CONFIDENTIAL

UNLESS OTHERWISE SPECIFIED:

MPF PRODUCTS INC.

ANY REPRODUCTION IN PART OR AS A WHOLE WITHOUT THE
WRITTEN PERMISSION OF MPF PRODUCTS INC. IS PROHIBITED.

USED ON:

DIMENSIONS ARE IN INCHES
TOLERANCES:

ANGULAR: MACH: $1/2^{\circ}$
TWO PLACE DECIMAL
THREE PLACE DECIMAL



$\pm .030$
 $\pm .015$

FINISH
CONFLAT

DRAWN BY

JB

DATE

CHECKED

ENG. APPR.

JB

SIZE

A

DWG. NO.

A6328-1-CF

REV

10/3/2013

LAST SAVED DATE

Thursday, October 03, 2013 4:09:41 PM