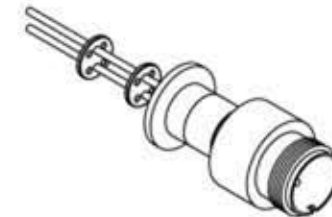
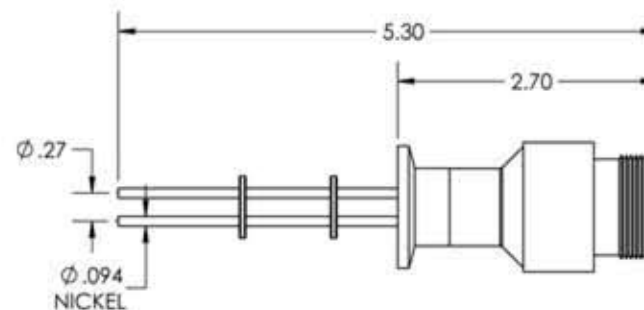
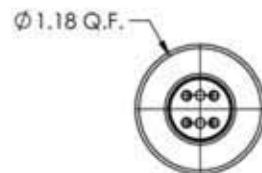

A2567-1-QF

REV
5/3/2013

APPROVED

MS High Current Series, Multipin Feedthrough, 2 Pins, 700 Volts, 16 Amps per Pin, 0.094" Nickel Conductors, 1.18" Quick Flange

TITLE:

MULTIPIN, 2 PIN, 700V, 16A, QF16

PROPRIETARY AND CONFIDENTIAL

UNLESS OTHERWISE SPECIFIED:

MPF PRODUCTS INC.

ANY REPRODUCTION IN PART OR AS A WHOLE WITHOUT THE WRITTEN PERMISSION OF MPF PRODUCTS INC. IS PROHIBITED.

DIMENSIONS ARE IN INCHES
TOLERANCES:

ANGULAR: MACH ± 1/2 °
TWO PLACE DECIMAL
THREE PLACE DECIMAL



± .030
± .015

FINISH
QUICK FLANGE

DRAWN BY

JB

DATE

CHECKED

ENG APPR.

JB

SIZE

A

DWG. NO.

A2567-1-QF

REV

5/3/2013

LAST SAVED DATE

Tuesday, April 23, 2013 9:30:51 AM