

A0757-2-CF

REV

5/3/2013

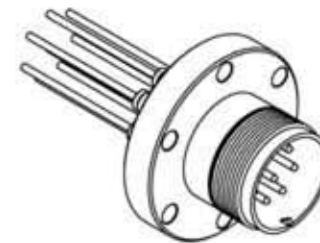
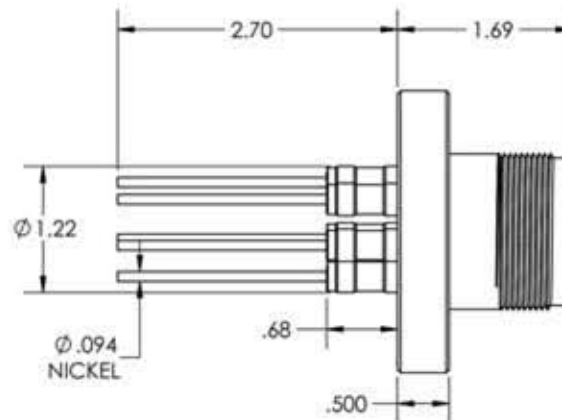
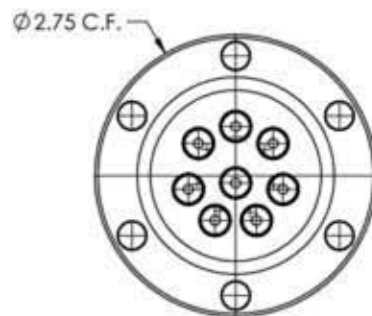

APPROVED

MS High Current Series, Multipin Feedthrough, 8 Pins, 700 Volts, 15 Amps per Pin, 0.094" Nickel Conductors, 2.75" Conflat Flange

TITLE:

MULTIPIN, 8 PIN, 700V, 15A, 275CF

PROPRIETARY AND CONFIDENTIAL

UNLESS OTHERWISE SPECIFIED:

MPF PRODUCTS INC.

ANY REPRODUCTION IN PART OR AS A WHOLE WITHOUT THE WRITTEN PERMISSION OF MPF PRODUCTS INC. IS PROHIBITED.

USED ON:

DIMENSIONS ARE IN INCHES  
TOLERANCES:

ANGULAR: MACH ± 1/2 °  
TWO PLACE DECIMAL  
THREE PLACE DECIMAL



± .030  
± .015

FINISH  
CF FLANGE

DRAWN BY  
JB

DATE

CHECKED

DO NOT SCALE DRAWING

ENG APPR. JB

SIZE

A

DWG. NO.

A0757-2-CF

REV

5/3/2013

LAST SAVED DATE

Tuesday, April 23, 2013 8:47:06 AM