

A0197

REV

5/28/2013

NOTES:

* TYPE K:

ALUMEL CONDUCTORS HAVE A NEGATIVE POLARITY (**MAGNETIC**) AND THE VACUUM SIDE ENDS ARE FLAT.
CHROMEL CONDUCTORS HAVE A POSITIVE POLARITY (**NON - MAGNETIC**) AND THE VACUUM SIDE ENDS HAVE A RADIUS.

* TYPE J:

CONSTANTAN CONDUCTORS HAVE A NEGATIVE POLARITY (**NON - MAGNETIC**) AND THE VACUUM SIDE ENDS ARE FLAT.
IRON CONDUCTORS HAVE A POSITIVE POLARITY (**MAGNETIC**) AND THE VACUUM SIDE ENDS HAVE A RADIUS.

* TYPE E:

CONSTANTAN CONDUCTORS HAVE A NEGATIVE POLARITY (**NON - MAGNETIC**) AND THE VACUUM SIDE ENDS ARE FLAT.
CHROMEL CONDUCTORS HAVE A POSITIVE POLARITY (**NON - MAGNETIC**) AND THE VACUUM SIDE ENDS HAVE A RADIUS.

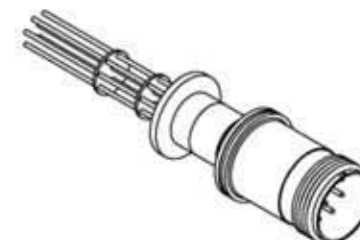
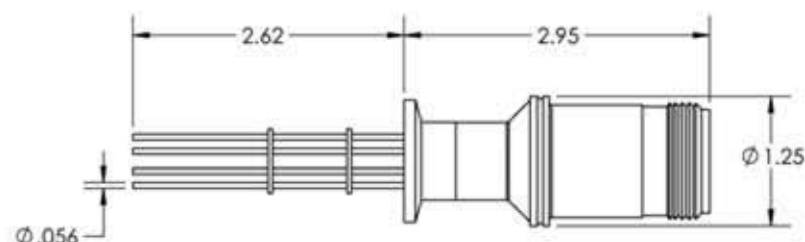
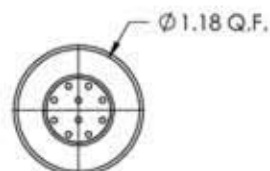

PART #	T/C TYPE	# OF PAIRS
A0197-1-QF	K	2
A0197-2-QF	J	2
A0197-3-QF	E	2
A0197-5-QF	K	3
A0197-6-QF	J	3
A0197-7-QF	E	3
A0197-9-QF	K	5
A0197-10-QF	J	5
A0197-11-QF	E	5

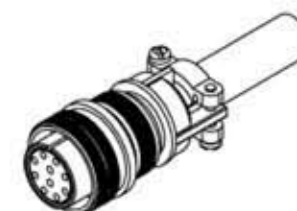

APPROVED

MS Series, Thermocouple Feedthrough 2, 3, and 5 Pairs, Type K, J, and E, w/ Air-side Connector
1.18" Quick Flange

TITLE:

THERMOCOUPLE, 2, 3, AND 5 PAIRS
TYPE K, J AND E
MS CONNECTOR, QF16

PROPRIETARY AND CONFIDENTIAL

UNLESS OTHERWISE SPECIFIED:

MPF PRODUCTS INC.

ANY REPRODUCTION IN PART OR AS A WHOLE WITHOUT THE
WRITTEN PERMISSION OF MPF PRODUCTS INC. IS PROHIBITED.

DIMENSIONS ARE IN INCHES
TOLERANCES:

ANGULAR: MACH ± 1/2 °
TWO PLACE DECIMAL
THREE PLACE DECIMAL



FINISH
QUICK FLANGE

DO NOT SCALE DRAWING

DRAWN BY

JB

DATE

CHECKED

ENG APPR.

JB

SIZE

A

DWG. NO.

A0197

REV

5/28/2013

LAST SAVED DATE

Tuesday, May 14, 2013 9:02:43 AM