

A0429

REV

5/28/2013

NOTES:

* TYPE K:

ALUMEL CONDUCTORS HAVE A NEGATIVE POLARITY (**MAGNETIC**) AND THE VACUUM SIDE ENDS ARE FLAT.
CHROMEL CONDUCTORS HAVE A POSITIVE POLARITY (**NON - MAGNETIC**) AND THE VACUUM SIDE ENDS HAVE A RADIUS.

* TYPE J:

CONSTANTAN CONDUCTORS HAVE A NEGATIVE POLARITY (**NON - MAGNETIC**) AND THE VACUUM SIDE ENDS ARE FLAT.
IRON CONDUCTORS HAVE A POSITIVE POLARITY (**MAGNETIC**) AND THE VACUUM SIDE ENDS HAVE A RADIUS.

* TYPE E:

CONSTANTAN CONDUCTORS HAVE A NEGATIVE POLARITY (**NON - MAGNETIC**) AND THE VACUUM SIDE ENDS ARE FLAT.
CHROMEL CONDUCTORS HAVE A POSITIVE POLARITY (**NON - MAGNETIC**) AND THE VACUUM SIDE ENDS HAVE A RADIUS.



0.747
WELD
ADAPTER

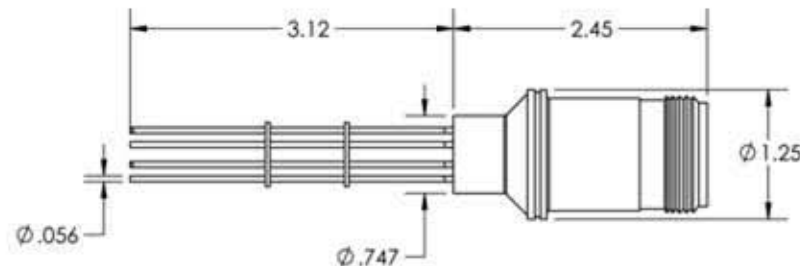

PART #	T/C TYPE	# OF PAIRS
A0429-1-W	K	2
A0429-2-W	J	2
A0429-3-W	E	2
A0429-5-W	K	3
A0429-6-W	J	3
A0429-7-W	E	3
A0429-9-W	K	5
A0429-10-W	J	5
A0429-11-W	E	5

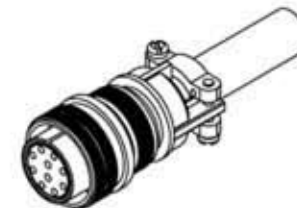

APPROVED

MS Series, Thermocouple Feedthrough 2, 3, and 5 Pairs, Type J, K, and E, w/ Air-side Connector, 0.75" Dia Stainless Steel Weld Adapter.

TITLE:

THERMOCOUPLE 2, 3, AND 5 PAIRS
TYPE J, K, AND E
MS CONNECTOR, WELD

PROPRIETARY AND CONFIDENTIAL

UNLESS OTHERWISE SPECIFIED:

MPF PRODUCTS INC.

ANY REPRODUCTION IN PART OR AS A WHOLE WITHOUT THE WRITTEN PERMISSION OF MPF PRODUCTS INC. IS PROHIBITED.

USED ON:

DIMENSIONS ARE IN INCHES
TOLERANCES:

ANGULAR: MACH ± 1/2 °
TWO PLACE DECIMAL
THREE PLACE DECIMAL



± .030
± .015

FINISH

WELDABLE

DO NOT SCALE DRAWING

DRAWN BY

JB

DATE

CHECKED

ENG APPR.

JB

SIZE

A

DWG. NO.

A0429

REV

5/28/2013

LAST SAVED DATE

Monday, May 13, 2013 9:56:20 AM