

A0499

REV

8/21/2013

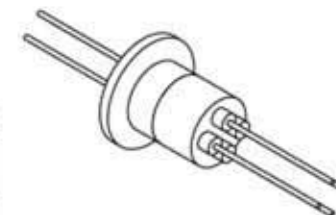
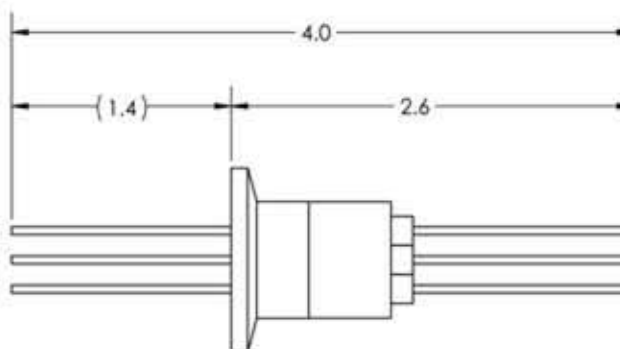
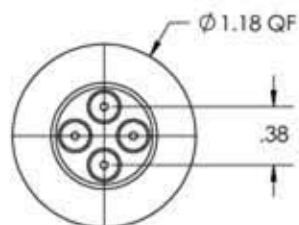

Ø .050
SEE TABLE
FOR CONDUCTOR
MATERIAL

PART #	CONDUCTOR MATERIAL	AMPS
A0499-1-QF	NICKEL	8
A0499-2-QF	STN STL	1
A0499-3-QF	OFHC COPPER	25
A0499-4-QF	MOLYBDENUM	13

APPROVED

Power Feedthrough, 1000 Volts, 4 Pins, 0.050" Conductors, 1.18" Quick Flange

TITLE:

POWER, 1KV, 4PIN, QF16

PROPRIETARY AND CONFIDENTIAL

UNLESS OTHERWISE SPECIFIED:

MPF PRODUCTS INC.

ANY REPRODUCTION IN PART OR AS A WHOLE WITHOUT THE WRITTEN PERMISSION OF MPF PRODUCTS INC. IS PROHIBITED.

DIMENSIONS ARE IN INCHES
TOLERANCES:ANGULAR: MACH ± 1/2 °
TWO PLACE DECIMAL
THREE PLACE DECIMAL± .030
± .015FINISH
QUICK FLANGE

DRAWN BY

JB

DATE

CHECKED

JB

DO NOT SCALE DRAWING

ENG APPR.

JB

SIZE
A

DWG. NO.

A0499

REV

8/21/2013

LAST SAVED DATE

Tuesday, August 20, 2013 9:34:50 AM