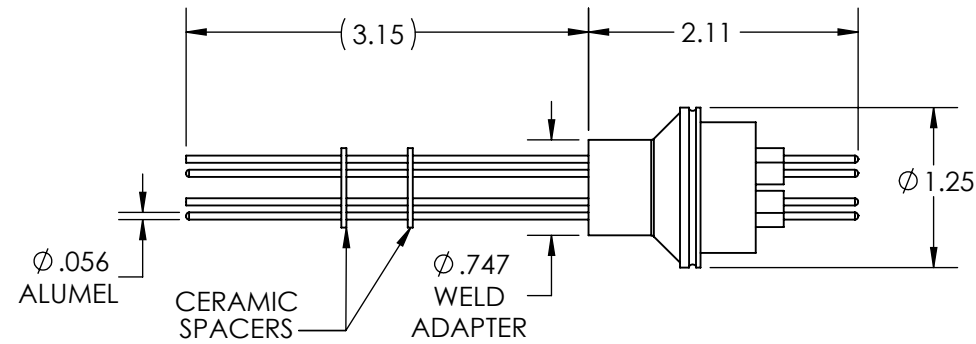
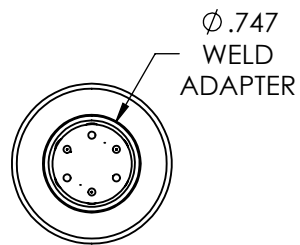
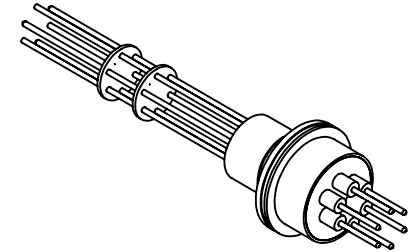

A0422-4-W

REV
8/21/2013

APPROVED

Power Feedthrough, 2000 Volts, 10 Amps, 6 Pins, 0.056" Alumel Conductors
0.747" Dia Stainless Steel Weld Adapter

TITLE:

POWER, 2KV, 10A, 6PIN, ALUMEL, WELD

PROPRIETARY AND CONFIDENTIAL

UNLESS OTHERWISE SPECIFIED:

MPF PRODUCTS INC.

ANY REPRODUCTION IN PART OR AS A WHOLE WITHOUT THE WRITTEN PERMISSION OF MPF PRODUCTS INC. IS PROHIBITED.

USED ON:

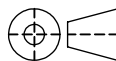
DIMENSIONS ARE IN INCHES
TOLERANCES:ANGULAR: MACH $\pm 1/2^\circ$
TWO PLACE DECIMAL
THREE PLACE DECIMAL $\pm .030$
 $\pm .015$ FINISH
WELDABLE

DO NOT SCALE DRAWING

DRAWN BY

JB

DATE

CHECKED

ENG APPR.

JB

SIZE
A

DWG. NO.

A0422-4-W

REV

8/21/2013

LAST SAVED DATE

Tuesday, August 20, 2013 10:30:36 AM