

A0526

REV

8/21/2013

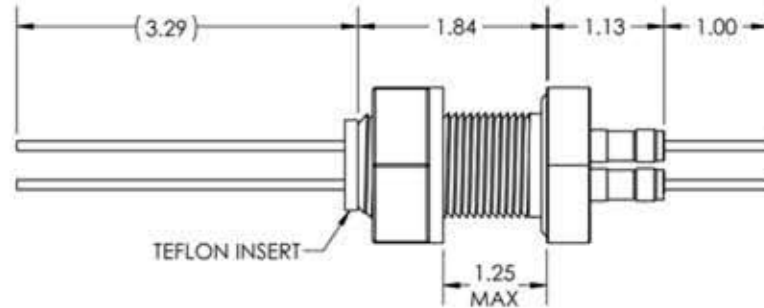
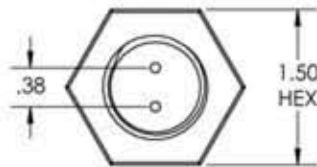
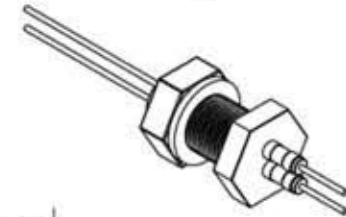

Ø .094
SEE TABLE
FOR CONDUCTOR
MATERIAL

PART #	CONDUCTOR MATERIAL	AMPS
A0526-1-BP	OFHC COPPER	50
A0526-2-BP	NICKEL	15
A0526-3-BP	STN STL	3

APPROVED

Power Feedthrough, 2000 Volts, 2 Pins, 0.094" Conductors, 1.0" Baseplate Bolt

TITLE:

POWER, 2KV, 2PIN, BASEPLATE

PROPRIETARY AND CONFIDENTIAL		UNLESS OTHERWISE SPECIFIED:		MPF PRODUCTS INC.				
ANY REPRODUCTION IN PART OR AS A WHOLE WITHOUT THE WRITTEN PERMISSION OF MPF PRODUCTS INC. IS PROHIBITED.		DIMENSIONS ARE IN INCHES TOLERANCES:			FINISH	DRAWN BY	JB	DATE
USED ON:		ANGULAR: MACH ± 1/2 ° TWO PLACE DECIMAL THREE PLACE DECIMAL			BASEPLATE	CHECKED		
				±.030 ±.015	DO NOT SCALE DRAWING	ENG APPR.	JB	

SIZE	DWG. NO.	REV
A	A0526	
LAST SAVED DATE		Tuesday, August 20, 2013 11:19:39 AM