

MPF PRODUCTS INC.

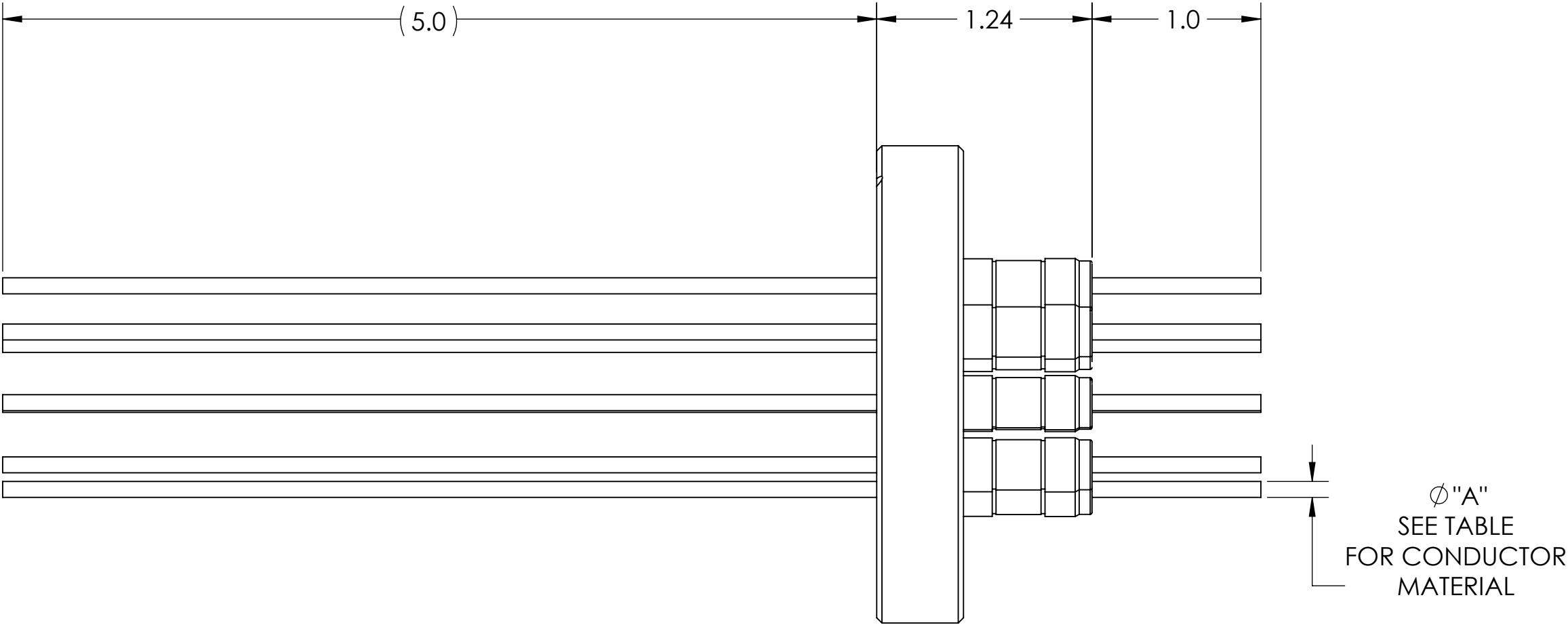
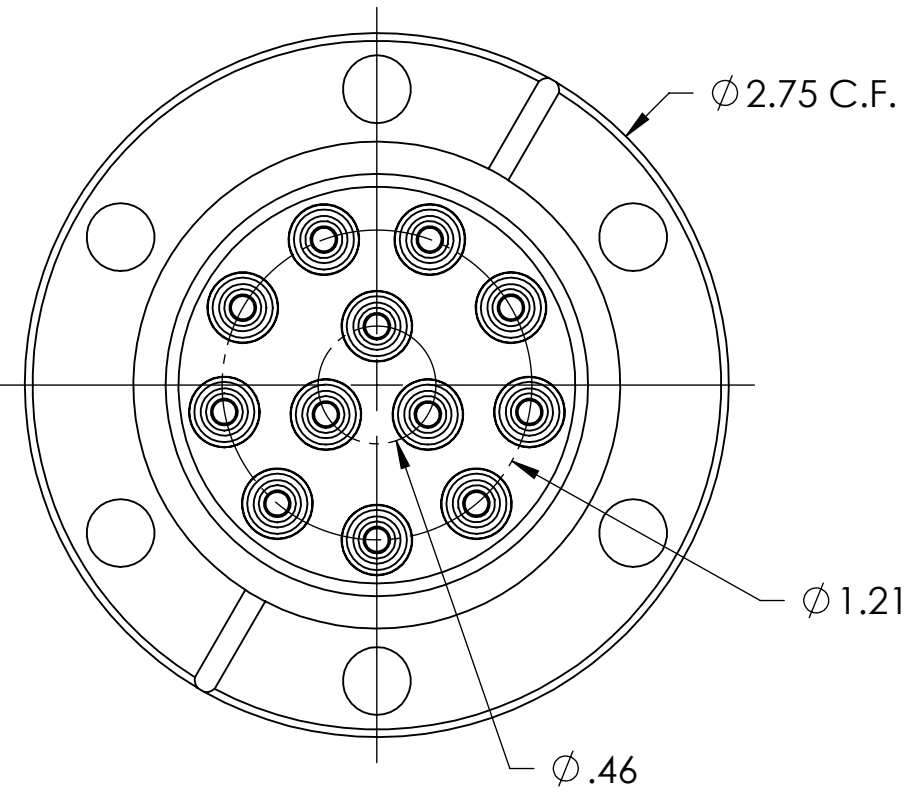

PART #	Ø "A"	COND. MATERIAL	AMPS
A0283-1-CF	.092	NICKEL-200	15
A0283-3-CF	.094	OFHC COPPER	50
A0283-5-CF	.094	MOLYBDENUM	28

POWER FEEDTHROUGH, 5000 VOLTS, 12 PINS, 2.75" CONFLAT FLANGE.

UNLESS OTHERWISE SPECIFIED:		QUOTATION #		APPROVED	
DIMENSIONS ARE IN INCHES TOLERANCES: ANGULAR: MACH ± 1/2° TWO PLACE DECIMAL ± .030 THREE PLACE DECIMAL ± .015 MATERIAL		DRAWN	NAME	DATE	MPF PRODUCTS INC. TITLE: POWER, 5KV, 12 PIN, 275CF DOWNLOADED FROM MPFPI.COM DWG. NO. A0283 REV
		WJ	WJ	8/24/2015	
		CHECKED	WJ	8/24/2015	
		ENG APPR.	WJ	8/24/2015	
FINISH CONFLAT PLATING		THIRD ANGLE:			
		APPLICATION NEXT ASSY USED ON			
		SURFACE FINISH: 63/ OR BETTER			
		UNLESS OTHERWISE SPECIFIED:			
		ALL DIAMETERS CONCENTRIC WITHIN .005. REMOVE ALL BURRS AND SHARP EDGES		Monday, August 24, 2015 9:45:43 AM	