

A5975-1-QF

REV
9/11/2013

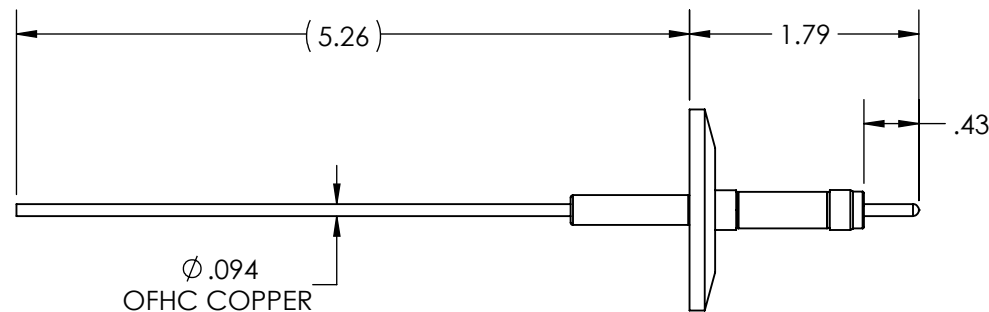

INCLUDES 96" AIRSIDE CONNECTOR / CABLE ASSEMBLY
(PART #A2459-2-CN)

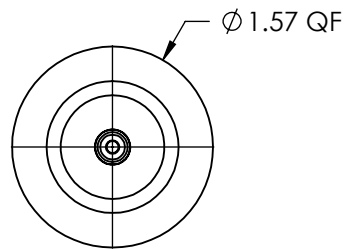
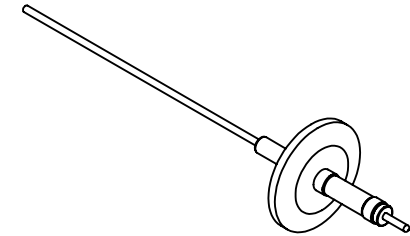
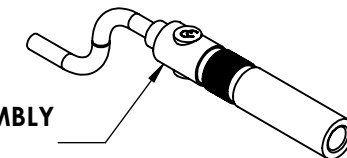

APPROVED

Power Feedthrough with Power Glove Connector, 10,000 Volts, 30 Amps, 1 Pin, 0.094" Copper Conductor
1.57" Quick Flange

TITLE:

POWER GLOVE, 10KV, 30A, 1PIN, QF25

PROPRIETARY AND CONFIDENTIAL

UNLESS OTHERWISE SPECIFIED:

MPF PRODUCTS INC.

ANY REPRODUCTION IN PART OR AS A WHOLE WITHOUT THE
WRITTEN PERMISSION OF MPF PRODUCTS INC. IS PROHIBITED.

DIMENSIONS ARE IN INCHES
TOLERANCES:

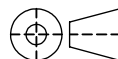

ANGULAR: MACH $\pm 1/2^\circ$
TWO PLACE DECIMAL
THREE PLACE DECIMAL

$\pm .030$
 $\pm .015$

FINISH
QUICK FLANGE

DRAWN BY

JB

DATE

CHECKED

ENG APPR.

JB

DO NOT SCALE DRAWING

SIZE
A

DWG. NO.
A5975-1-QF

REV

9/11/2013

LAST SAVED DATE

Wednesday, September 11, 2013 7:08:53 AM