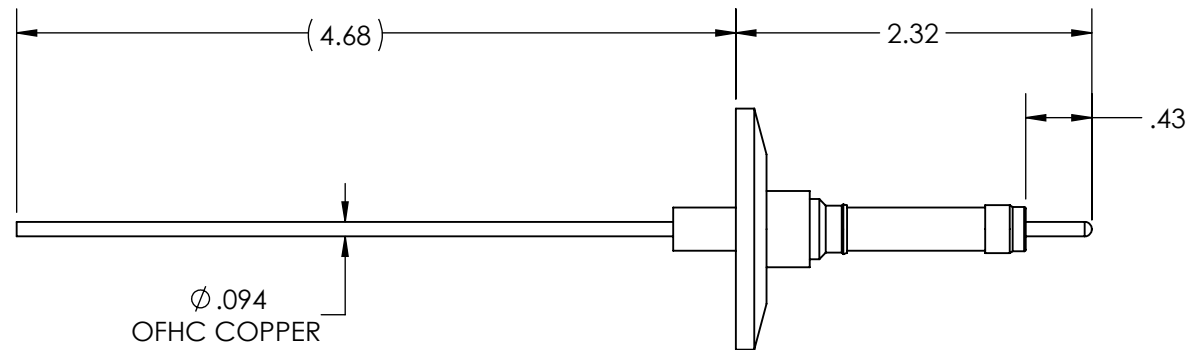
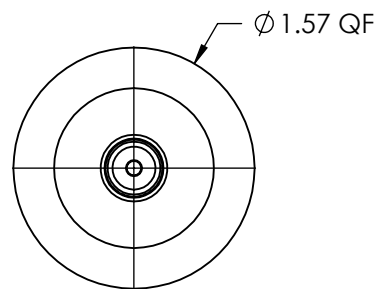
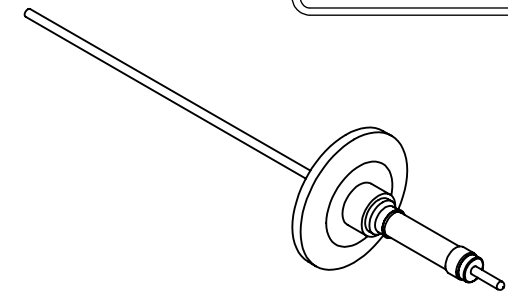
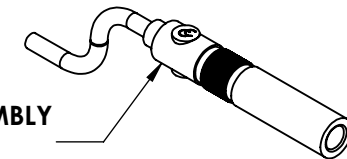

A5983-1-QF

REV
9/11/2013

INCLUDES 96" AIRSIDE CONNECTOR / CABLE ASSEMBLY
(PART #A2459-2-CN)

**APPROVED**

Power Feedthrough with Power Glove Connector, 20,000 Volts, 30 Amps, 1 Pin, 0.094" Copper Conductor
1.57" Quick Flange

TITLE:

POWER GLOVE, 20KV, 30A, 1PIN, QF25

PROPRIETARY AND CONFIDENTIAL

UNLESS OTHERWISE SPECIFIED:

MPF PRODUCTS INC.

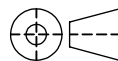
ANY REPRODUCTION IN PART OR AS A WHOLE WITHOUT THE
WRITTEN PERMISSION OF MPF PRODUCTS INC. IS PROHIBITED.DIMENSIONS ARE IN INCHES
TOLERANCES:ANGULAR: MACH $\pm 1/2^\circ$
TWO PLACE DECIMAL
THREE PLACE DECIMAL $\pm .030$
 $\pm .015$ FINISH
QUICK FLANGE

DRAWN BY

JB

DATE

CHECKED

ENG APPR.

JB

DO NOT SCALE DRAWING

SIZE

A

DWG. NO.

A5983-1-QF

REV

9/11/2013

LAST SAVED DATE

Wednesday, September 11, 2013 7:07:44 AM

USED ON: