

A4214-1-CN

REV

11/19/2013

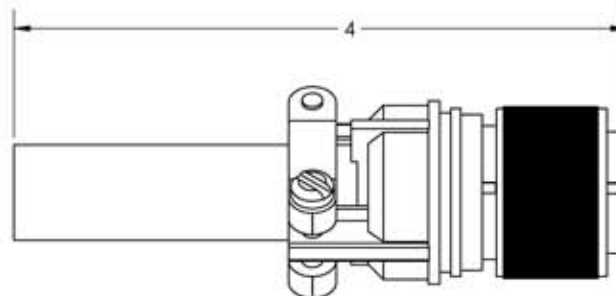
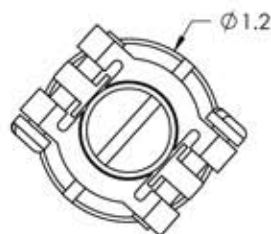

TEMPERATURE RATING: UP TO 125°C

APPROVED

MS Series Air-side Connector, 4 Pins, 12000 Volts, 7.5 Amps per Pin, Accepts 0.040" Dia Pins

TITLE:

MS CIRCULAR CONNECTOR,
12KV, 7.5A, 4 PIN

PROPRIETARY AND CONFIDENTIAL

UNLESS OTHERWISE SPECIFIED:

MPF PRODUCTS INC.

ANY REPRODUCTION IN PART OR AS A WHOLE WITHOUT THE
WRITTEN PERMISSION OF MPF PRODUCTS INC. IS PROHIBITED.

USED ON:

DIMENSIONS ARE IN INCHES
TOLERANCES:

ANGULAR: MACH ± 1/2°
TWO PLACE DECIMAL
THREE PLACE DECIMAL



±.030
±.015

FINISH
CONNECTOR

DRAWN BY

JB

DATE

11/15/2013

CHECKED

WJ

11/15/2013

ENG APPR.

JB

11/15/2013

DO NOT SCALE DRAWING

SIZE

A

DWG. NO.

A4214-1-CN

REV

11/19/2013

LAST SAVED DATE

Tuesday, November 19, 2013 2:28:51 PM