

A1178-1-CN

REV

11/18/2013

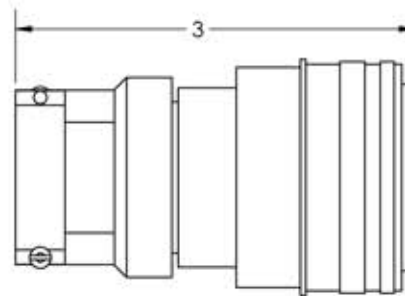
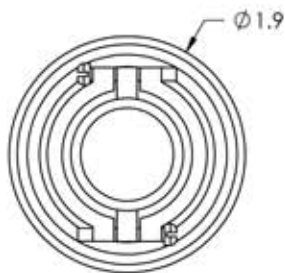
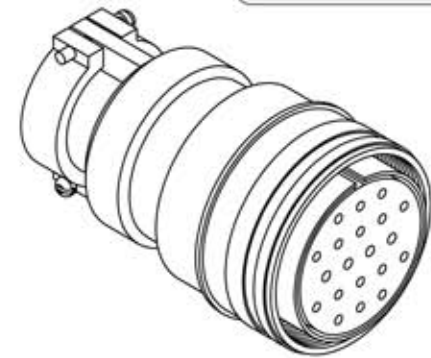

TEMPERATURE RATING: UP TO 350°C

MS Series Vacuum Side Connector, 10 Pair Thermocouple, Type J, Accepts 0.056" Pins

APPROVED

TITLE:

MS CIRCULAR  
THERMOCOUPLE CONNECTOR,  
10 PAIR, TYPE J

PROPRIETARY AND CONFIDENTIAL

UNLESS OTHERWISE SPECIFIED:

MPF PRODUCTS INC.

ANY REPRODUCTION IN PART OR AS A WHOLE WITHOUT THE  
WRITTEN PERMISSION OF MPF PRODUCTS INC. IS PROHIBITED.DIMENSIONS ARE IN INCHES  
TOLERANCES:ANGULAR: MACH ± 1/2°  
TWO PLACE DECIMAL  
THREE PLACE DECIMAL±.030  
±.015FINISH  
CONNECTOR

DRAWN BY

JB

DATE

CHECKED

ENG APPR.

JB

DO NOT SCALE DRAWING

SIZE

A

DWG. NO.

A1178-1-CN

REV

11/18/2013

LAST SAVED DATE

Monday, November 18, 2013 11:20:27 AM