

A0209

REV
5/28/2013

NOTES:

* TYPE K:

ALUMEL CONDUCTORS HAVE A NEGATIVE POLARITY (**MAGNETIC**) AND THE VACUUM SIDE ENDS ARE FLAT.
CHROMEL CONDUCTORS HAVE A POSITIVE POLARITY (**NON - MAGNETIC**) AND THE VACUUM SIDE ENDS HAVE A RADIUS.

* TYPE J:

CONSTANTAN CONDUCTORS HAVE A NEGATIVE POLARITY (**NON - MAGNETIC**) AND THE VACUUM SIDE ENDS ARE FLAT.
IRON CONDUCTORS HAVE A POSITIVE POLARITY (**MAGNETIC**) AND THE VACUUM SIDE ENDS HAVE A RADIUS.

* TYPE E:

CONSTANTAN CONDUCTORS HAVE A NEGATIVE POLARITY (**NON - MAGNETIC**) AND THE VACUUM SIDE ENDS ARE FLAT.
CHROMEL CONDUCTORS HAVE A POSITIVE POLARITY (**NON - MAGNETIC**) AND THE VACUUM SIDE ENDS HAVE A RADIUS.

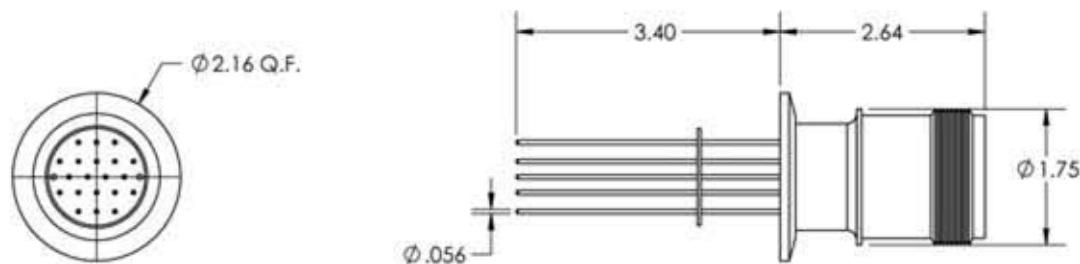

PART #	T/C TYPE
A0209-1-QF	K
A0209-2-QF	J
A0209-3-QF	E

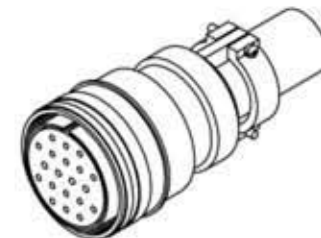
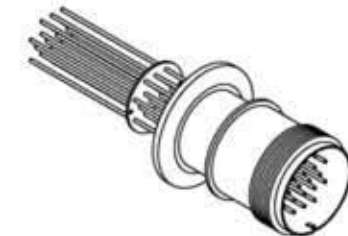

APPROVED

MS Series, Thermocouple Feedthrough, 10 Pairs, Type K, J, and E, w/ Air-side Connector, 2.16" Quick Flange

TITLE:

THERMOCOUPLE, 10 PAIR
TYPE K, J AND E
MS CONNECTOR, QF40

PROPRIETARY AND CONFIDENTIAL

UNLESS OTHERWISE SPECIFIED:

MPF PRODUCTS INC.

ANY REPRODUCTION IN PART OR AS A WHOLE WITHOUT THE
WRITTEN PERMISSION OF MPF PRODUCTS INC. IS PROHIBITED.

DIMENSIONS ARE IN INCHES
TOLERANCES:

ANGULAR: MACH ± 1/2 °
TWO PLACE DECIMAL
THREE PLACE DECIMAL



FINISH
QUICK FLANGE

DRAWN BY

JB

DATE

CHECKED

JB

DO NOT SCALE DRAWING

ENG APPR.

JB

SIZE

A

DWG. NO.

A0209

REV

5/28/2013

LAST SAVED DATE

Tuesday, May 14, 2013 9:03:32 AM